

Cabinet Member for City Services

2 July 2018

Name of Cabinet Member:

Cabinet Member for City Services – Councillor J Innes

Director Approving Submission of the report:

Deputy Chief Executive (Place)

Ward(s) affected:

Bablake

Title: Petition - Wallace Road, State of the Grass Verges and Request for Parking Solution for the Shops

Is this a key decision?

No

Executive Summary:

A petition of 60 signatures has been received requesting that the Council address the state of the grass verges on Wallace Road and look into a suitable parking solution for residents and customers of the shops on Wallace Road.

In accordance with the City Council's procedure for dealing with petitions, those relating to verges and parking are heard by the Cabinet Member for City Services. The Cabinet Member had considered this petition prior to this meeting and in response to the issues raised requested that the petition was dealt with by letter (determination letter), rather than a formal report being submitted to a meeting, to be able to deal with the matter more efficiently.

The determination letter advised of the action proposed and approved in response to the issue raised. On receipt of the determination letter, the petitioner has confirmed that they do not wish the petition to be solely progressed by letter and want their requests to be considered at a Cabinet Member for City Services meeting.

The cost of making changes to highway verges is usually funded from the Highways Maintenance and Investment Capital Programme budget through the Local Transport Plan.

Recommendations:

The Cabinet Member for City Services is recommended to:

- 1) Note the petitioners' concerns.
- 2) Endorse that the actions confirmed by determination letter to the petition spokesperson (as detailed in paragraph 1.6 of the report) are undertaken.
- 3) Approve the reinstatement of missing bollards outside the parade of shops on Wallace Road (as detailed in paragraph 2.2 of the report)

List of Appendices included:

Appendix A – Location Plan

Appendix B – Determination letter

Background Papers

None

Other useful documents:

None

Has it been or will it be considered by Scrutiny?

No

Has it been or will it be considered by any other Council Committee, Advisory Panel or other body?

No

Will this report go to Council?

No

Report title: Petition - Wallace Road, State of the Grass Verges and Request for Parking Solution for the Shops

1. Context (or background)

1.1 A petition of 60 signatures has been received requesting that the Council address the state of the grass verges on Wallace Road and look into a suitable parking solution for residents and customers of the shops on Wallace Road.

1.2 The petition advises:

“We the undersigned ask Coventry City Council to address the state of the grass verges along the whole of Wallace Road on both sides, as well as looking into a suitable parking solution for residents and customers of the shops on Wallace Road.”

1.3 Wallace Road is a local distributor road between Keresley Road and Sadler Road in Bablake Ward. On the southern side, there is a parade of shops opposite the junction with Dickens Road. Wallace Road is also on a bus route. A location plan is shown in Appendix A.

1.4 A safety scheme was consulted on and implemented in 2008/9 in response to safety concerns raised by residents. This included the current parking arrangements outside the parade of shops. A plan of the scheme is shown in Appendix B. On a recent site visit, it was noted that some of the bollards installed at each end of the verge outside the shops are missing. As a result, vehicles are accessing the verge adjacent to the footway and parking off the carriageway. It appears that some vehicles are also driving along the footway to pass other vehicles parked on the verge.

1.5 In accordance with the City Council's procedure for dealing with petitions, those relating to verges and parking are heard by the Cabinet Member for City Services. The Cabinet Member considered the petition prior to this meeting and in response requested that the issue was dealt with by determination letter rather than a formal report being submitted to a meeting, to be able to deal with the matter more efficiently.

1.6 The determination letter (copy provided in Appendix C of this report) advised that Wallace Road is already on the list of requests for consideration for a verge protection scheme. Due to the number of requests received for similar schemes city-wide, requests have to be prioritised in line with the verge protection policy and are dependent on the availability of funding. Wallace Road did not qualify for inclusion in the 2018/19 verge scheme programme. Therefore, it will remain on the request list for consideration for inclusion in a future year's programme.

2 Options considered and recommended proposal

2.1 For safety reasons, it is proposed to reinstate the missing bollards outside the shops to prevent vehicles driving onto the footway and verge at this location.

2.2 As already approved and detailed in the determination letter, Wallace Road will remain on the list of requests for consideration for a verge protection scheme in a future year's programme.

2.3 It is not proposed to reconfigure the parking outside the shops. Conversion of the verge into a parking area would not create additional spaces, as it would remove the spaces available on the road. Echelon parking would not be considered for safety reasons, as the location is opposite a junction.

3. Results of consultation undertaken

3.1 No consultation has been undertaken.

4. Timetable for implementing this decision

4.1 Subject to approval, the missing bollards would be replaced this financial year.

5. Comments from Director of Finance and Corporate Resources

5.1 Financial implications

The cost of reinstating the missing bollards will be funded from the Highways Maintenance and Investment Capital Programme budget through the Local Transport Plan.

5.2 Legal implications

There are no legal implications of the recommended proposal.

6. Other implications

6.1 How will this contribute to achievement of the Council's key objectives / corporate priorities (corporate plan/scorecard) / organisational blueprint / Local Area Agreement (or Coventry Sustainable Community Strategy)?

The reinstatement of the missing bollards will contribute to the City Council's aims of ensuring that citizens, especially children and young people, are safe and the objective of working for better pavements, streets and roads.

6.2 How is risk being managed?

None

6.3 What is the impact on the organisation?

None

6.4 Equalities / EIA

No specific equalities impact assessment has been carried out.

6.5 Implications for (or impact on) the environment

None

6.6 Implications for partner organisations?

None

Report author(s)**Name and job title:**

Martin Wilkinson, Senior Officer - Traffic Management

Directorate:

Place

Tel and email contact:

Tel: 024 7683 3265

Email: martin.wilkinson@coventry.gov.uk

Enquiries should be directed to the above person.

Contributor/approver name	Title	Directorate or organisation	Date doc sent out	Date response received or approved
Contributors:				
Colin Knight	Director (Transportation and Highways)	Place	8/6/18	8/6/18
Colin Whitehouse	Highway Development Manager	Place	8/6/18	8/6/18
Caron Archer	Team Leader (Traffic Management)	Place	21/6/18	22/6/18
Liz Knight/Michelle Salmon	Governance Services Officers	Place	8/6/18	8/6/18
Names of approvers: (Officers and Members)				
Graham Clark	Lead Accountant	Place	8/6/18	8/6/18
Rob Parkes	Commercial Lawyer, Legal Services	Place	8/6/18	8/6/18
Councillor J Innes	Cabinet Member for City Services	-	8/6/18	18/6/18

This report is published on the council's website: moderngov.coventry.gov.uk

Appendix A – Location Plan

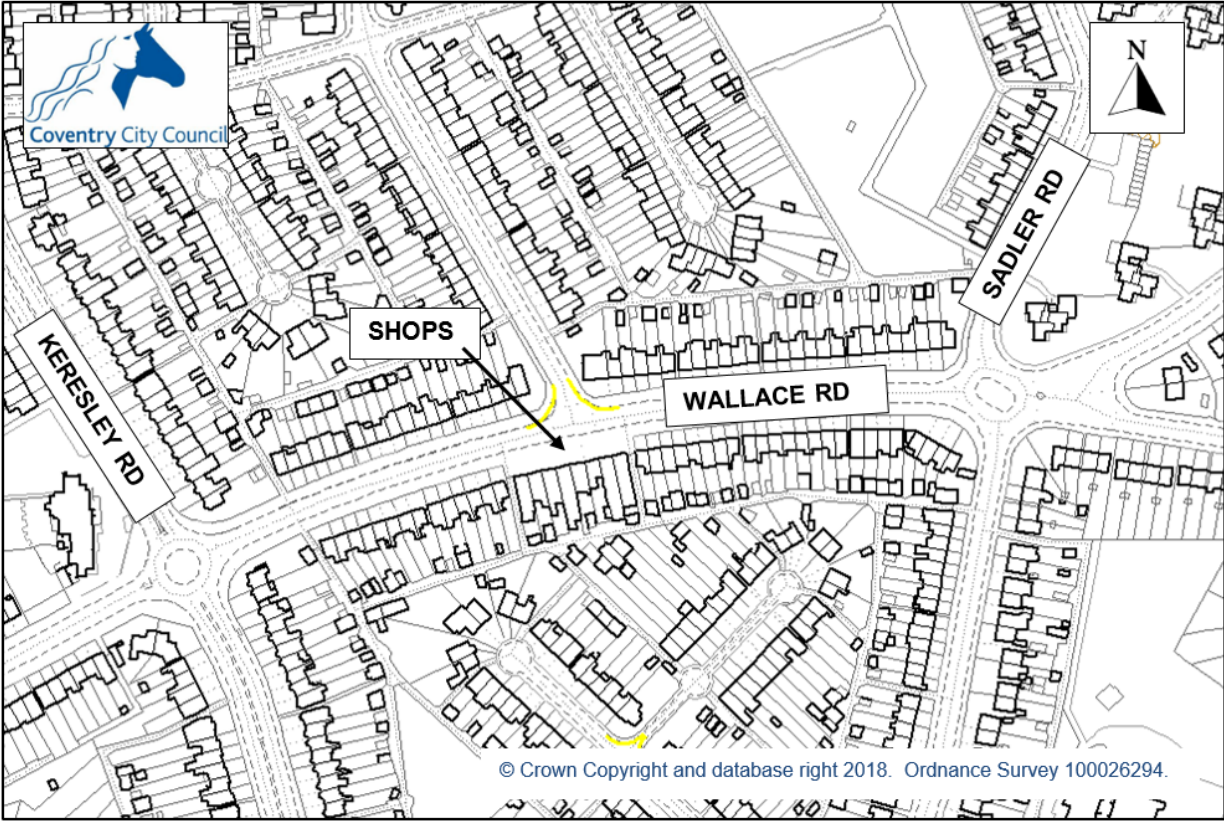

Appendix B – Safety scheme implemented in 2008/9

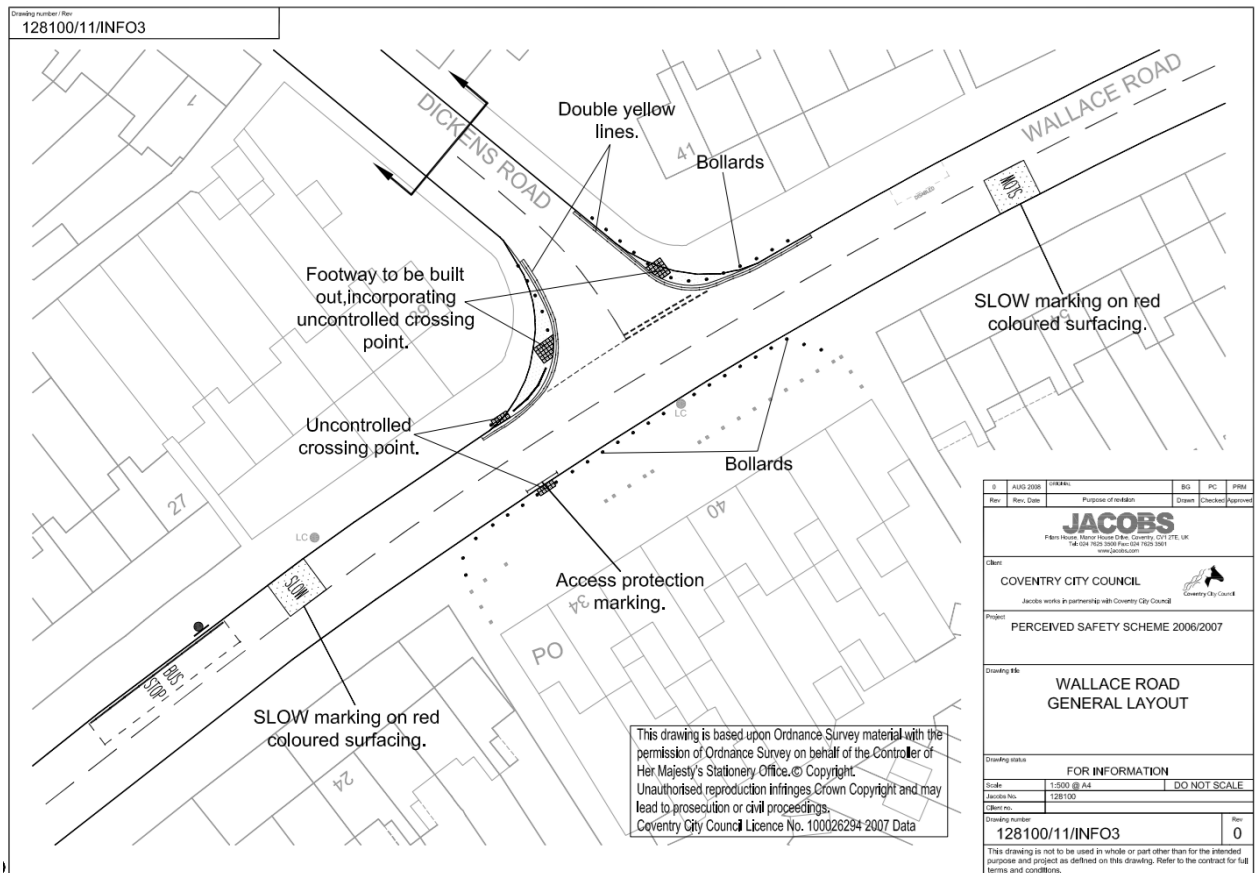

This drawing is based upon Ordnance Survey material with the permission of Ordnance Survey on behalf of the Controller of Her Majesty's Stationery Office. © Copyright. Unauthorised reproduction infringes Crown Copyright and may lead to prosecution or civil proceedings. Coventry City Council Licence No. 100026294 2007 Data

Rev	Rev. Date	Purpose of revision	Drawn	Checked	Approved
0	AUG 2008				
JACOBS <small>Flem House, Manor Road, Coventry, CV5 9EF, UK Tel: 024 7634 1000 Fax: 024 7634 1001 www.jacobs.com</small>					
Client: COVENTRY CITY COUNCIL					
Project: PERCEIVED SAFETY SCHEME 2006/2007					
Drawing title: WALLACE ROAD GENERAL LAYOUT					
Drawing status: FOR INFORMATION					
Scale:	1:500 (B1 A4)	DO NOT SCALE			
Jacobs No:	128100				
Client no:					
Drawing number:	128100/11/INFO3	Rev: 0			
This drawing is not to be used in whole or part other than for the intended purposes and project as defined on this drawing. Refer to the contract for full terms and conditions.					

Appendix C – Copy of Text of Determination Letter

Re: petition submitted on 1 March 2017

Subject matter: 65-16 Petition - Wallace Road, State of the Grass Verges and Request for Parking Solution for the Shops

I am writing with regard to the above petition and your request for measures to address the condition of the grass verges and address parking issues outside the shops on Wallace Road. Please accept my apologies for the delay in responding formally to your petition.

The matter was discussed with Councillor Innes, Cabinet Member for City Services, who has requested that this be dealt with by way of letter rather than a formal report being submitted to a future meeting.

The Council's verge protection policy acknowledges the conflict between those who wish to see verges protected and those who wish to use them for parking. At present, the City Council does not have sufficient resources to satisfy all of the numerous requests we receive from residents across the city for verge protection measures.

Notwithstanding the above, Wallace Road is already on the list of requests for consideration for a verge protection scheme. This includes the area outside the shops. Due to the number of requests received for similar schemes city-wide, requests have to be prioritised in line with the verge protection policy and are dependent on the availability of funding.

Wallace Road did not qualify for inclusion in the 2018/19 verge scheme programme. Therefore, it will be retained as a possible future location for works. If it is prioritised for inclusion in a future year's programme, we will contact you again with further details.